

SURVEYOR'S OFFICE  
**Hamilton County**

*Kenton C. Ward, CFM*  
*Surveyor of Hamilton County*  
*Phone (317) 776-8495*  
*Fax (317) 776-9628*

*Suite 188*  
*One Hamilton County Square*  
*Noblesville, Indiana 46060-2230*

October 6, 2008

To: Hamilton County Drainage Board

Re: Bliss Johnson Drain, Mill Grove Arm

Attached is a petition and plans for the proposed relocation of the Bliss Johnson Drain, Mill Grove Arm. The relocation is being proposed by Platinum Properties, LLC. The proposal is to relocate the drain across the following parcels as part of the Mill Grove Section 9 & Section 7 project per Section 9 Record Drawings by Stoeppelwerth & Assoc., Job. No. 31083S9 dated June 16, 2008 and per Section 6 plans, Job No. 31083, Revision date January 22, 2002 and per Section 7 plans, Job No. 31083, Revision date July 28, 2004.

Parcel 11-06-34-00-02-007.000, owned by Platinum Properties, LLC  
Parcel 11-06-27-00-08-036.000, owned by Platinum Properties, LLC  
Parcel 11-06-27-00-15-001.000, owned by Cate, Russell B. & Jennifer N.  
Parcel 11-06-34-00-02-006.000, owned by RH of Indiana LP  
Dado Ct. Right of way, owned by City of Noblesville  
Parcel 11-06-34-00-01-007.000, owned by Hummel, Nicholas J. & Jennifer E.  
Parcel 11-06-34-00-01-006.000, owned by Taylor, Megan N. & Sean G.  
Parcel 11-06-34-00-01-005.000, owned by Fritsche, Andrew J. & Rachel L.  
Parcel 11-06-34-00-02-001.000, owned by Bongard, Daniel T. Carole L.  
Parcel 11-06-34-00-01-004.000, owned by Mills, Gregory P. & Julia Holcombe Jt/Rs  
Pilot Mills Ct. Right of way, owned by City of Noblesville  
Parcel 11-06-27-00-14-003.000, owned by Brewer, Robert E. & Kimberly S.  
Parcel 11-06-34-00-01-001.000, owned by Metelmann, Paul A. Julia A.  
Parcel 10-06-27-00-09-056.001, owned by Platinum Properties  
Parcel 11-06-34-00-01-008.000, owned by Platinum Properties  
Parcel 10-06-27-00-11-058.001, owned by Platinum Properties  
Parcel 10-06-34-00-00-003.000, owned by M & E McMahan LLC

Per the plans stormwater is routed through Mill Grove Subdivision via a combination of open ditch, storm sewer and ponds. This drain relocation includes the main trunk line from the existing culvert under Little Chicago Road to the open drain downstream of Mill Grove where the open ditch is currently regulated drain (Sta. 67+42).

This line will consist of the following:

**Bliss Johnson Drain – Mill Grove Arm Drain Lengths**

| <u>Str. To Str.</u>          | <u>Length</u> | <u>Size</u> | <u>Type</u>              |
|------------------------------|---------------|-------------|--------------------------|
| Existing culvert to Str. 294 | 85'           | -           | Open Ditch w/paved swale |
| Str. 294-295                 | 228'          | 60"         | RCP                      |
| Str. 295-296                 | 203'          | 60"         | RCP                      |
| Str. 296-297                 | 369'          | 60"         | RCP                      |
| Str. 297-288                 | 295'          |             | Lake                     |
| Str. 288-289                 | 207'          | 36"         | HDPE                     |
| Str. 289-290                 | 90'           | -           | Lake                     |
| Str. 290-291                 | 40'           | 30"         | RCP                      |
| Str. 291 – Sta.67+42         | 127'          | -           | Open Ditch               |

The total length of the new drain shall be 1,644 feet. The 1,288 feet of original Bliss Johnson Drain and easement between Sta. 54+54 and 67+42 shall be vacated. This proposal will add 356 feet to the drain's total length. The stationing corresponds with my previous report for the Bliss Johnson Drain, Little Chicago Road Improvements Phase 1 Project, dated June 6, 2008 and approved by the Drainage Board on June 9, 2008 as recorded in Minutes Book 11, Page 195-196. The original stationing of the Bliss Johnson Drain is per the viewer report filed with the Hamilton Circuit Court on July 27, 1940.

The cost of the relocation is to be paid by Platinum Properties LLC. The developer has provided the Performance Bond as follows:

Name of Bonding Company: Bond Safeguard Insurance Company  
 Bond # 5027925  
 Bond Date: May 17, 2007  
 Bond Amount: \$133,644.00

Attached is a non-enforcement request. The easements for the new drain will be the drainage easements per the secondary plats for Mill Grove Section 9A recorded as Instrument No. 2007060559, Plat Cabinet 4, Slide 385; Mill Grove Section 7 recorded as Instrument No. 200400003335, Plat Cabinet 3, Slide 321; and, Mill Grove Section 6B

recorded as Instrument No. 2003000076277, Plat Cabinet 3, Slide 219 in the Hamilton County Recorder's Office. I recommend approval of the non-enforcement by the Board.

The detention ponds located in Common Areas 22 & 27 are to be considered part of the regulated drain. Pond maintenance shall include inlet, outlet, sediment removal and erosion control along the banks as part of the regulated rain. The maintenance of the ponds, such as mowing and aquatic vegetation control, will be the responsibility of the Homeowners Association. The Board will also retain jurisdiction for ensuring the storage volume for which the ponds were designed will be retained, thereby, allowing no fill or easement encroachments.

I recommend that this drain be classified as an urban drain.

I recommend that the Board set a hearing date for November 24, 2008.

Sincerely,

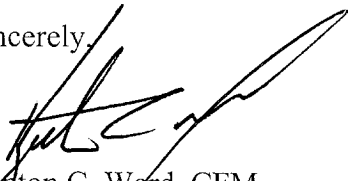

Kenton C. Ward, CFM  
Hamilton County Surveyor

KCW/pll

STATE OF INDIANA        )  
  )  
COUNTY OF HAMILTON )

TO: HAMILTON COUNTY DRAINAGE BOARD  
% Hamilton County Surveyor  
One Hamilton County Square, Suite 188  
Noblesville, IN. 46060-2230

In the matter of Mill Grove Subdivision, Section  
**Nine A** Drain Petition.

Petitioner is the owner of all lots in the land affected by the proposed new regulated drain. The drainage will affect various lots in Mill Grove, Section Nine A, a subdivision in Hamilton County, Indiana. The general route of such drainage shall be in existing easements and along public roads as shown in the plans on file in the Surveyor's Office.

Petitioner believes that the cost, damages and expenses of the proposed improvement will be less than the benefits which will result to the owners of the land likely to be benefited thereby. Petitioner believes the proposed improvements will:

- (a) improve public health
- (b) benefit a public street
- (c) be of public utility

Petitioner agrees to pay the cost of construction of the drainage system and requests periodic maintenance assessments by the Board thereafter.

The Petitioner also agrees to the following:

1. To provide the Drainage Board a Performance Bond or Non-Revocable Letter of Credit for the portion of the drainage system which will be made a regulated drain. The bond will be in the amount of 120% of the Engineer's estimate. The bond will be in effect until construction of 100% of the system is completed and so certified by the Engineer.
2. The Petitioner shall retain an Engineer throughout the construction phase. At completion of the project the Petitioner's Engineer shall certify that the drainage system which is to be maintained as a regulated drain has been constructed as per construction plans.
3. The Petitioner agrees to request in writing to the County Surveyor any changes from the approved plan and must receive written authorization from the County Surveyor prior to implementation of the change. All changes shall be documented and given to the Surveyor to be placed in the Drain file.
4. The Petitioner shall instruct his Engineer to provide a reproducible print on a 24" x 36" Mylar of the final design of the Drainage System. This shall be submitted to the County Surveyor prior to the release of the Performance Bond.
5. The Petitioner shall comply with the Erosion Control Plan as specified on the construction plans. Failure to comply with the Erosion Control Plan shall be determined by the Board as being an obstruction to the drainage system. The County Surveyor shall immediately install or repair the needed measures at Petitioners cost as per IC 36-9-27-46.

The Petitioner further requests that the Drain be classified as an Urban Drain as per IC 36-9-27-69(d).

**RECORDED OWNER(S) OF LAND INVOLVED**

*Kenneth Brasseur*  
Signed

**Kenneth Brasseur**  
Printed Name

**March 27, 2006**  
Date

\_\_\_\_\_  
Signed

\_\_\_\_\_  
Printed Name

\_\_\_\_\_  
Date

\_\_\_\_\_  
Signed

\_\_\_\_\_  
Printed Name

\_\_\_\_\_  
Date

\_\_\_\_\_  
Signed

\_\_\_\_\_  
Printed Name

\_\_\_\_\_  
Date

IN RE: \_\_\_\_\_ )  
Hamilton County, Indiana )

PETITION FOR RELOCATION AND RECONSTRUCTION

\_\_\_\_\_ Platinum Properties, LLC \_\_\_\_\_ (hereinafter "Petitioner"),  
hereby petitions the Hamilton County Drainage Board for authority to relocate and improve a  
section of the \_\_\_\_\_ Bliss Johnson \_\_\_\_\_ Drain, and in support of  
said petition advises the Board that:

1. Petitioner owns real estate through which a portion of the \_\_\_\_\_ Bliss Johnson \_\_\_\_\_  
Drain runs.
2. Petitioner plans to develop its real estate with roads, buildings, utilities, storm drains,  
sanitary sewers and other structures.
3. Petitioner's proposed development of its real estate will require relocation and  
reconstruction of a portion of the \_\_\_\_\_ Bliss Johnson \_\_\_\_\_ Drain, as  
specifically shown on engineering plans and specifications filed with the Hamilton  
County Surveyor.
4. The work necessary for the proposed relocation and reconstruction will be undertaken at  
the sole expense of the Petitioner and such work will result in substantial improvement to  
the \_\_\_\_\_ Bliss Johnson \_\_\_\_\_ Drain, without cost to other property owners  
on the watershed of the \_\_\_\_\_ Bliss Johnson \_\_\_\_\_ Drain.

WHEREFORE, Petitioner requests that an Order issued from the Hamilton County  
Drainage Board authorizing relocation and reconstruction of the \_\_\_\_\_ Bliss Johnson \_\_\_\_\_  
Drain, in conformance with applicable law and plans and specifications on file with the Hamilton  
County Surveyor.

  
\_\_\_\_\_  
Signed  
Kenneth R. Brasseur  
\_\_\_\_\_  
Printed



Mill Grove Section 9  
 Engineers Estimate - Storm Sewers  
 Original: 5/15/07  
 By: NJR

| Item   | Unit         | Unit Cost   | Quantities | Cost              |
|--|--------------|-------------|------------|-------------------|
| <b>Storm Drainage</b>  |              |             |            |                   |
| 12" Pipe   | LF           | \$ -        |            | \$ -              |
| 12" End Section  | EA           | \$ -        |            | \$ -              |
| 12" Trash Guard  | EA           | \$ -        |            | \$ -              |
| 15" Pipe   | LF           | \$ 16.95    | 25         | \$ 424            |
| 15" End Section  | EA           | \$ 583.80   | 1          | \$ 584            |
| 15" Trash Guard  | EA           | \$ 200.00   | 1          | \$ 200            |
| 18" Pipe   | LF           | \$ -        |            | \$ -              |
| 18" End Section  | EA           | \$ -        |            | \$ -              |
| 18" Trash Guard  | EA           | \$ -        |            | \$ -              |
| 21" Pipe   | LF           | \$ -        |            | \$ -              |
| 21" End Section  | EA           | \$ -        |            | \$ -              |
| 21" Trash Guard  | EA           | \$ -        |            | \$ -              |
| 24" Pipe   | LF           | \$ -        |            | \$ -              |
| 24" End Section  | EA           | \$ -        |            | \$ -              |
| 24" Trash Guard  | EA           | \$ -        |            | \$ -              |
| 27" Pipe   | LF           | \$ -        |            | \$ -              |
| 27" End Section  | EA           | \$ -        |            | \$ -              |
| 27" Trash Guard  | EA           | \$ -        |            | \$ -              |
| 30" Pipe   | LF           | \$ -        |            | \$ -              |
| 30" End Section  | EA           | \$ -        |            | \$ -              |
| 30" Trash Guard  | EA           | \$ -        |            | \$ -              |
| 33" Pipe   | LF           | \$ -        |            | \$ -              |
| 33" End Section  | EA           | \$ -        |            | \$ -              |
| 33" Trash Guard  | EA           | \$ -        |            | \$ -              |
| 36" Pipe   | LF           | \$ -        |            | \$ -              |
| 36" End Section  | EA           | \$ -        |            | \$ -              |
| 36" Trash Guard  | EA           | \$ -        |            | \$ -              |
| 42" Pipe   | LF           | \$ -        |            | \$ -              |
| 42" End Section  | EA           | \$ -        |            | \$ -              |
| 42" Trash Guard  | EA           | \$ -        |            | \$ -              |
| 60" Pipe   | LF           | \$ 103.32   | 798        | \$ 82,449         |
| 60" End Section  | EA           | \$ 3,535.00 | 2          | \$ 7,070          |
| 60" Trash Guard  | EA           | \$ 1,000.00 | 2          | \$ 2,000          |
| Standard Storm Manholes  | EA           | \$ 1,550.20 | 1          | \$ 1,550          |
| Large Storm Manholes & Double Inlets   | EA           | \$ 7,752.50 | 2          | \$ 15,505         |
| Storm Inlets   | EA           | \$ -        |            | \$ -              |
| Sand Backfill and Bedding  | TON          | \$ 7.93     | 200.00     | \$ 1,586          |
|  | Sub-total    |             |            | \$ 111,370        |
|  | <b>Total</b> |             |            | <b>\$ 111,370</b> |
| <b>Monuments &amp; Markers</b>   |              |             |            |                   |
| --> Not Applicable - Property annexed by City of Noblesville and governed by Westfield MS4 permit. |              |             |            | \$ -              |
| <b>Total</b>   |              |             |            | \$ -              |
| <b>Erosion Control</b>   |              |             |            |                   |
| --> Not Applicable - Property annexed by City of Noblesville and governed by Westfield MS4 permit. |              |             |            | NA NA             |
| <b>Total</b>   |              |             |            | \$ -              |
| <b>Grand Total</b>   |              |             |            | <b>\$ 111,370</b> |
| Per Hamilton County Ordinance - Bond Amount  |              |             |            | 120% \$ 133,644   |

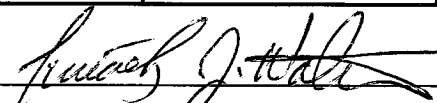
BY:   
 Timothy J. Walter, P.E.  
 Indiana Registration No. 19900152

BEFORE THE HAMILTON COUNTY DRAINAGE BOARD  
IN THE MATTER OF

**Bliss Johnson Drain, Mill Grove Arm**

NOTICE

To Whom It May Concern and: \_\_\_\_\_  
\_\_\_\_\_  
\_\_\_\_\_

Notice is hereby given of the hearing of the Hamilton County Drainage Board concerning the reconstruction of the **Bliss Johnson Drain, Mill Grove Arm** on **November 24, 2008**, at **9:05 A.M.** in Commissioners Court, Hamilton County Judicial Center, One Hamilton County Square, Noblesville, Indiana. Construction and maintenance reports of the Surveyor and the Schedule of Assessments proposed by the Drainage Board have been filed and are available for public inspection in the office of the Hamilton County Surveyor.

Hamilton County Drainage Board

Attest:Lynette Mosbaugh

ONE TIME ONLY



STATE OF INDIANA     )  
                          ) SS                   BEFORE THE HAMILTON  
                          )  
COUNTY OF HAMILTON )                   DRAINAGE BOARD

IN THE MATTER OF **Bliss Johnson Drain, Mill Grove Arm**

NOTICE

Notice is hereby given that the Hamilton County Drainage Board at its regular meeting **November 24, 2008** adopted the reconstruction report of the Surveyor and the Amended Schedule of damages and assessments including annual assessment for periodic maintenance, finding that the costs, damages and expense of the proposed improvement would be less than the benefits which will result to the owner of lands benefited thereby.

The Board issued an order declaring the proposed improvement established. Such findings and order were marked filed and are available for inspection in the Office of the Hamilton County Surveyor.

If judicial review of the findings and order of the Board is not requested pursuant to Article VIII of the 1965 Indiana Drainage Code as amended within twenty (20) days from the date of publication of this notice, the findings and order shall become conclusive.

HAMILTON COUNTY DRAINAGE BOARD

BY: Steven A. Holt  
PRESIDENT

ATTEST: Lynette Mosbaugh  
SECRETARY

FINDINGS AND ORDER

CONCERNING THE PARTIAL VACATION OF THE

**Bliss Johnson Drain, Mill Grove Arm  
Sta. 54+54 to Sta.67+42**

On this **24th day of November 2008**, the Hamilton County Drainage Board has held a hearing on the Maintenance Report and Schedule of Assessments of the **Bliss Johnson Drain, Mill Grove Arm, Sta. 54+54 to Sta. 67+42**.

Evidence has been heard. Objections were presented and considered. The Board then adopted an order of action. The Board now finds that the costs of continued maintenance to the portion of the above drain exceed the benefits to the real estate benefited by the portion of the drain to be abandoned and issues this order vacating the above section of the **Bliss Johnson Drain, Mill Grove Arm**.

HAMILTON COUNTY DRAINAGE BOARD

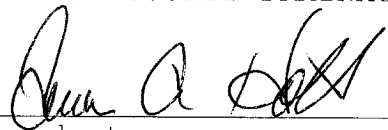
  
\_\_\_\_\_  
President

  
\_\_\_\_\_  
Member

  
\_\_\_\_\_  
Member

Attest:

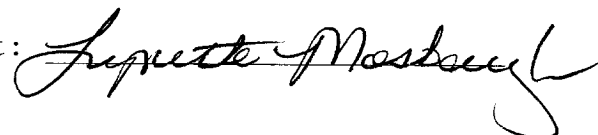

STATE OF INDIANA )  
 ) ss:  
COUNTY OF HAMILTON )

BEFORE THE HAMILTON COUNTY  
DRAINAGE BOARD  
NOBLESVILLE, INDIANA

IN THE MATTER OF THE  
RECONSTRUCTION OF THE  
**Bliss Johnson Drain, Mill Grove Arm**

FINDINGS AND ORDER FOR RECONSTRUCTION.

The matter of the proposed Reconstruction of the **Bliss Johnson Drain, Mill Grove Arm** came before the Hamilton County Drainage Board for hearing on **November 24, 2008**, on the Reconstruction Report consisting of the report and the Schedule of Damages and Assessments. The Board also received and considered the written objection of an owner of certain lands affected by the proposed Reconstruction, said owner being:

Evidence was heard on the Reconstruction Report and on the aforementioned objections.

The Board, having considered the evidence and objections, and, upon motion duly made, seconded and unanimously carried, did find and determine that the costs, damages and expenses of the proposed Reconstruction will be less than the benefits accruing to the owners of all land benefited by the Reconstruction.

The Board having considered the evidence and objections, upon motion duly made, seconded and unanimously carried, did adopt the Schedule of Assessments as proposed, subject to amendment after inspection of the subject drain as it relates to the lands of any owners which may have been erroneously included or omitted from the Schedule of Assessments.

The Board further finds that it has jurisdiction of these proceedings and that all required notices have been duly given or published as required by law.

Wherefore, it is ORDERED, that the proposed Reconstruction of the **Bliss Johnson Drain, Mill Grove Arm** be and is hereby declared established.

Thereafter, the Board made inspection for the purpose of determining whether or not the lands of any owners had been erroneously included or excluded from the Schedule of Assessments. The Board finds on the basis of the reports and findings at this hearing as follows:

HAMILTON COUNTY DRAINAGE BOARD

  
\_\_\_\_\_  
PRESIDENT

  
\_\_\_\_\_  
Member

  
\_\_\_\_\_  
Member

ATTEST

  
Executive Secretary



*Kenton C. Ward, CFM*  
*Surveyor of Hamilton County*  
*Phone (317) 776-8495*  
*Fax (317) 776-9628*

*Suite 188*  
*One Hamilton County Square*  
*Noblesville, Indiana 46060-2230*

**To: Hamilton County Drainage Board**

**February 26, 2009**

**Re: Bliss Johnson – Mill Grove Arm**

Attached are as-builts, certificate of completion & compliance, and other information for Mill Grove Arm. An inspection of the drainage facilities for this section has been made and the facilities were found to be complete and acceptable.

During construction, changes there were no significant changes made to the drainage plans submitted with my report for this drain dated October 6, 2008. The report was approved by the Board at the hearing held November 24, 2008 (See Drainage Board Minutes Book 11, Pages393-396). Therefore, the length of the drain remains at **1644 feet**.

The non-enforcement was approved by the Board at its meeting on November 24, 2008 and recorded under instrument # 2008058426.

The following sureties were guaranteed by Bond Safeguard Insurance Co. and released by the Board on its January 12, 2009 meeting.

**Bond-LC No: 5027925**  
**Insured For: Storm Sewers**  
**Amount: \$133,644.00**  
**Issue Date: May 17, 2007**

I recommend the Board approve the drain's construction as complete and acceptable.

Sincerely,

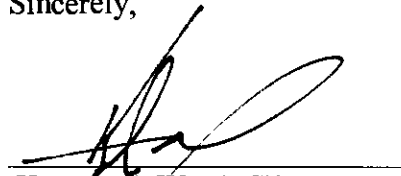

---

Kenton C. Ward, CFM  
Hamilton County Surveyor

KCW/slm

CERTIFICATE OF COMPLETION AND COMPLIANCE

To: Hamilton County Surveyor

Re: Mill Grove, Section 9

I hereby certify that:

1. I am a Registered Land Surveyor or Engineer in the State of Indiana.
2. I am familiar with the plans and specifications for the above referenced subdivision.
3. I have personally observed and supervised the completion of the drainage facilities for the above referenced subdivision.
4. The drainage facilities within the above referenced subdivision to the best of my knowledge, information and belief have been installed and completed in conformity with all plans and specifications.
5. The drainage facilities within the above referenced subdivision to the best of my knowledge, information and belief have been correctly represented on the Record Drawings, Digital Record Drawings and the Structure Data Spreadsheet.

Signature:  Date: June 13, 2008

Type or Print Name: Dennis D. Olmstead

Business Address: 7965 East 106th Street  
Fishers, Indiana 46038

Telephone Number: (317) 849-5935

SEAL

INDIANA REGISTRATION NUMBER

900012



SCALE: 1"=50' HOR.  
1"=5' VERT.

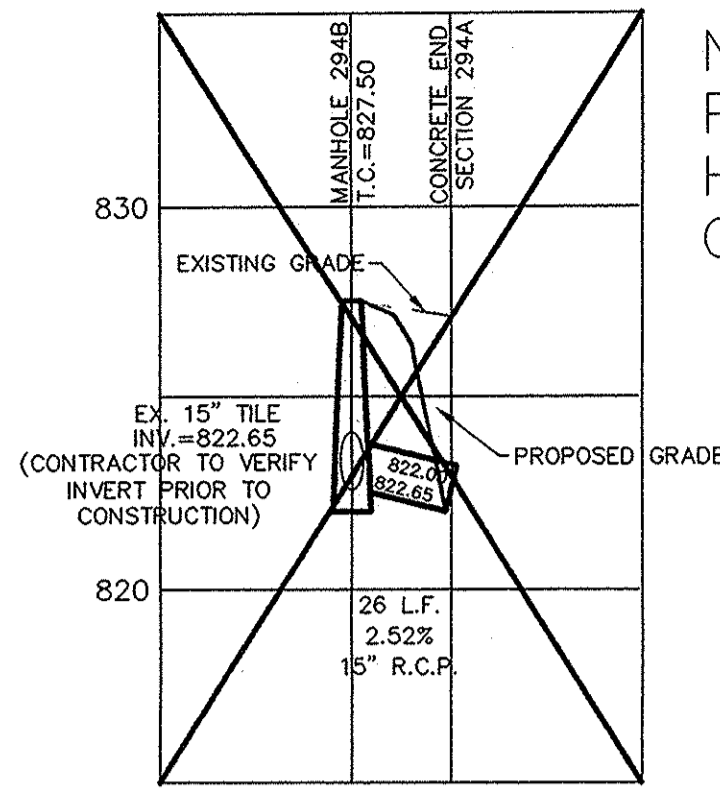

NOT INSTALLED  
PER JERRY LISTON  
HAMILTON CO. SURVEYORS  
OFFICE

SCALE: 1"=50' HOR.  
1"=5' VERT.

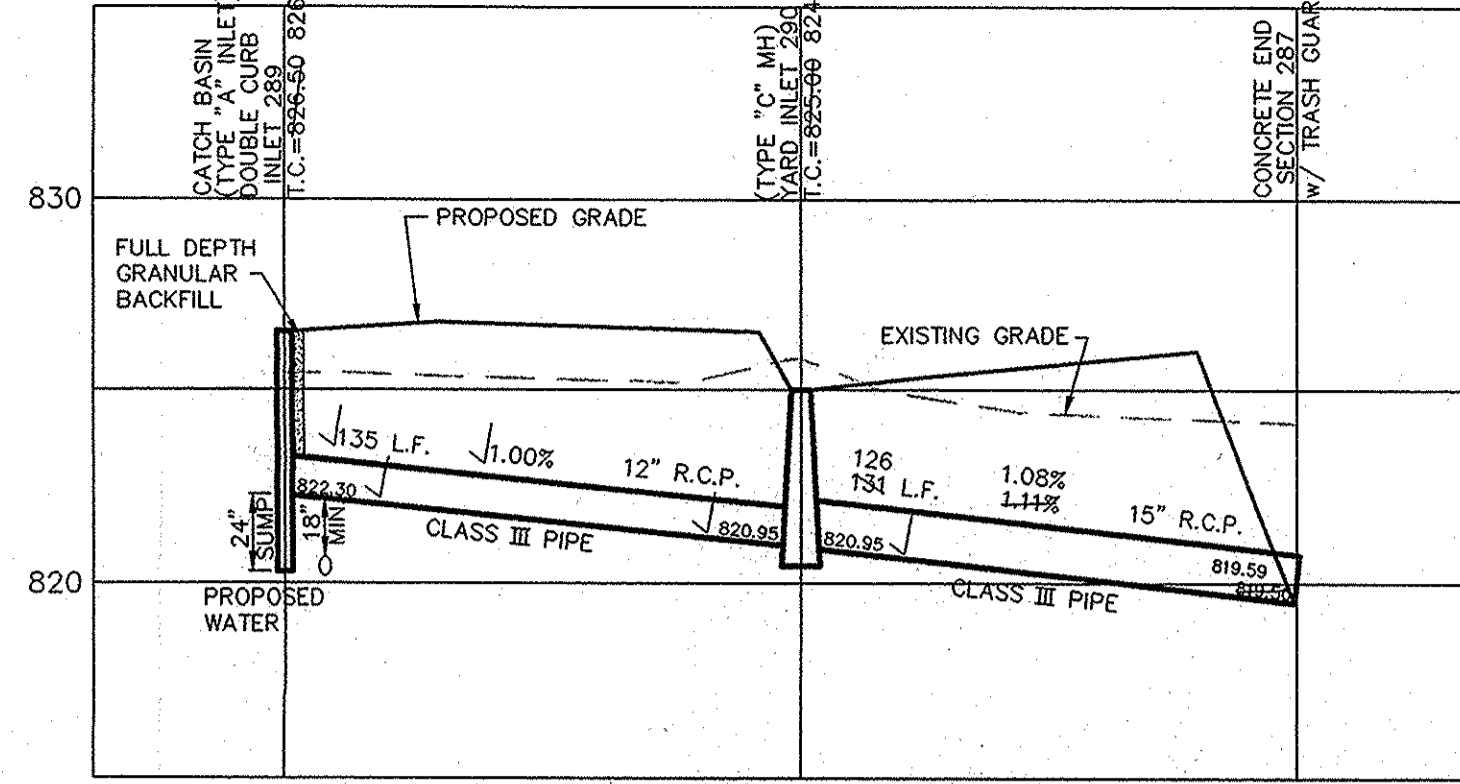

SCALE: 1"=50' HOR.  
1"=5' VERT.

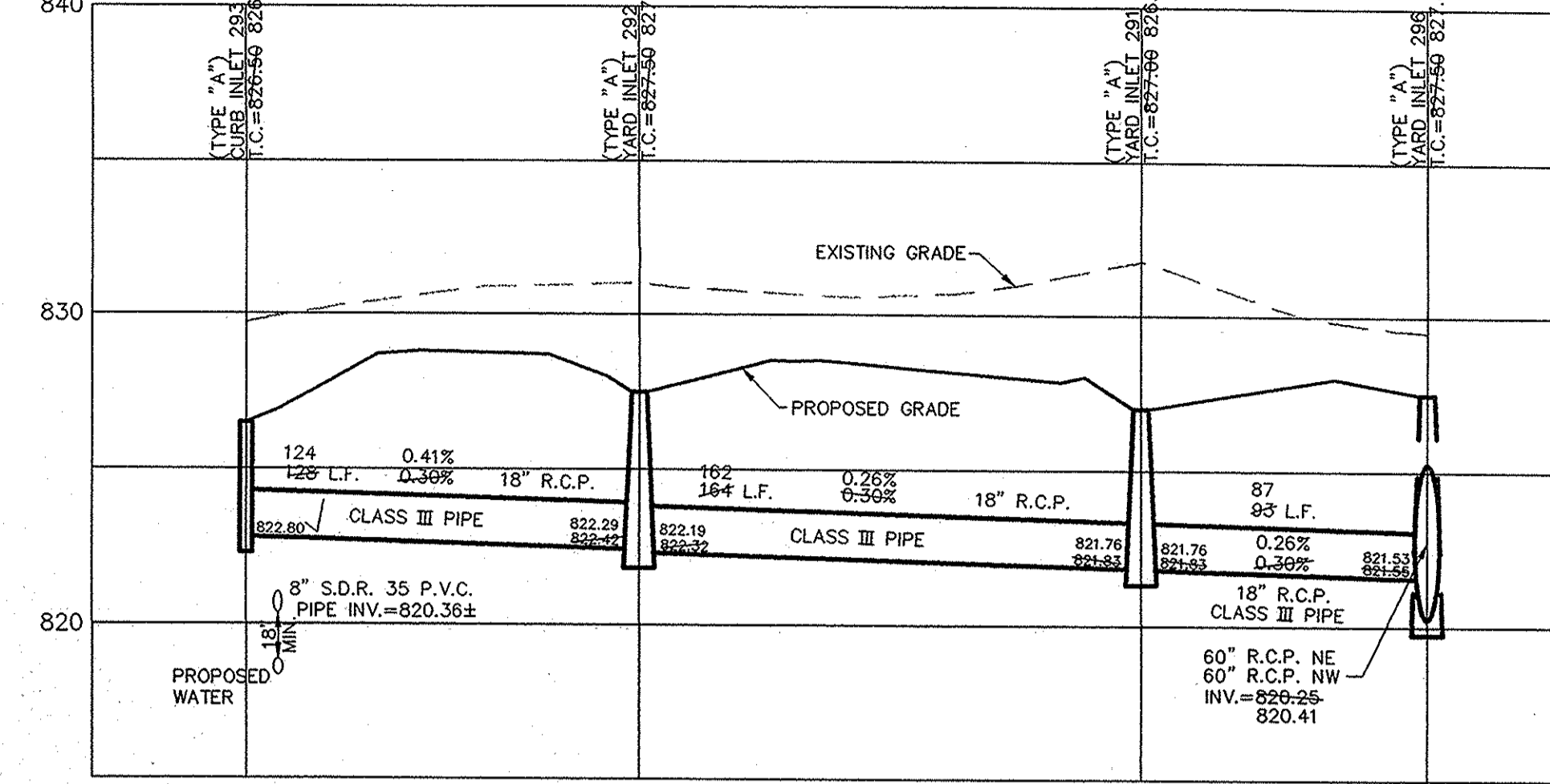

SCALE: 1"=50' HOR.  
1"=5' VERT.

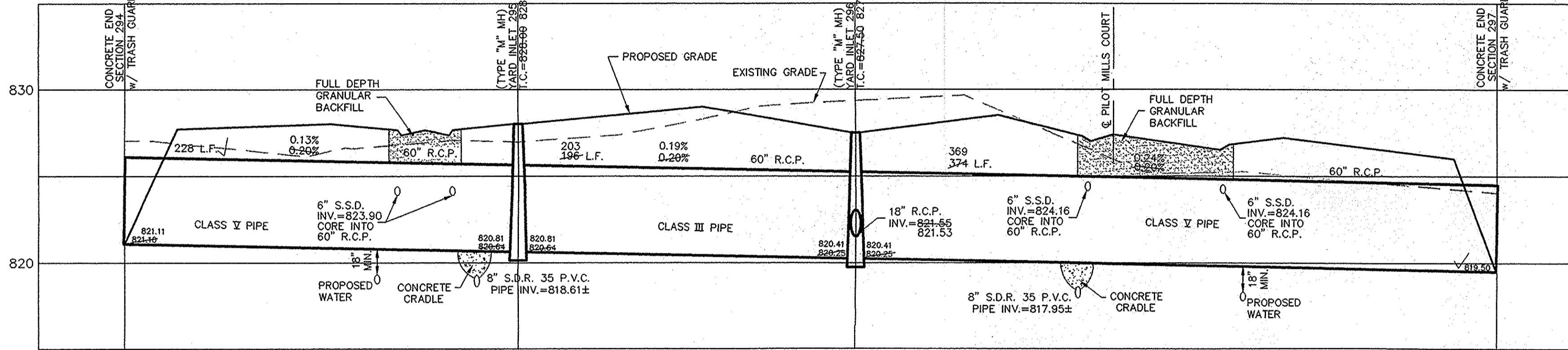

**DANGER! USE EXCESSIVE CAUTION!** PANHANDLE EASTERN PIPE LINE COMPANY HIGH PRESSURE NATURAL GAS PIPELINES. PANHANDLE MUST BE NOTIFIED (DIRECTLY AT 317/873-2410 AND THROUGH THE ONE-CALL CENTER AT 1-800-382-5444) TWO (2) WORKING DAYS IN ADVANCE OF ANY ACTIVITY WITHIN ITS EASEMENT AND HAVE A REPRESENTATIVE PRESENT DURING ANY EXCAVATION OVER OR ADJACENT TO ITS PIPELINES.

NOTE:  
CONSTRUCTION TOLERANCE FOR YARD INLETS  
WILL BE +0.0' TO -0.20'

NOTE:  
EXCEPT FOR FORCE MAINS, CONTRACTOR TO  
INSTALL CONCRETE CRADLES WHEN THE VERTICAL  
SEPARATION (AS MEASURED FROM THE EXTERIOR  
OF THE PIPES) BETWEEN SANITARY SEWER FACILITIES  
AND STORM SEWERS IS 18" OR LESS."

SCALE: 1" = 50'

NOTE:  
CONTRACTOR TO CRUSH AND/OR  
REMOVE REMAINDER OF EXISTING  
15" CLAY TILE FROM STR. 294B  
IN EXISTING ROAD.

EXISTING SECTION 7

RECORD DRAWING

*D.D.O.*  
DENNIS D. OLMSTEAD  
Registered Land Surveyor  
No. 900012

6/16/08  
DATE



STORM PLAN AND PROFILES  
MILL GROVE SECTION 9

DRAWN BY: BAH  
CHECKED BY: EEF  
SHEET NO.  
**C600**  
S & A JOB NO.  
3108359

STOEPPELWERTH & ASSOCIATES, INC.  
CONSULTING ENGINEERS & LAND SURVEYORS  
9940 Allisonville Rd., Fishers, IN 46038-2005  
Phone: (317) 849-5935 Fax: (317) 849-5942  
Toll Free: (800) 728-6917

CERTIFIED: 01/26/07

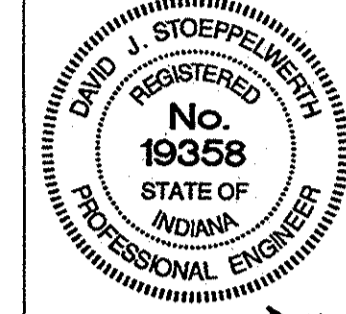

*David J. Stoepelwerth*

| DATE     | MARK | REVISIONS                 | BY      |
|----------|------|---------------------------|---------|
| 01/10/07 |      | REVISE PER DEVELOPER      | JOH     |
| 10/10/07 |      | ASBUILTS                  | BAH/MGR |
| 06/13/08 |      | ADDED AS-BUILT CLEAN OUTS | BKR     |

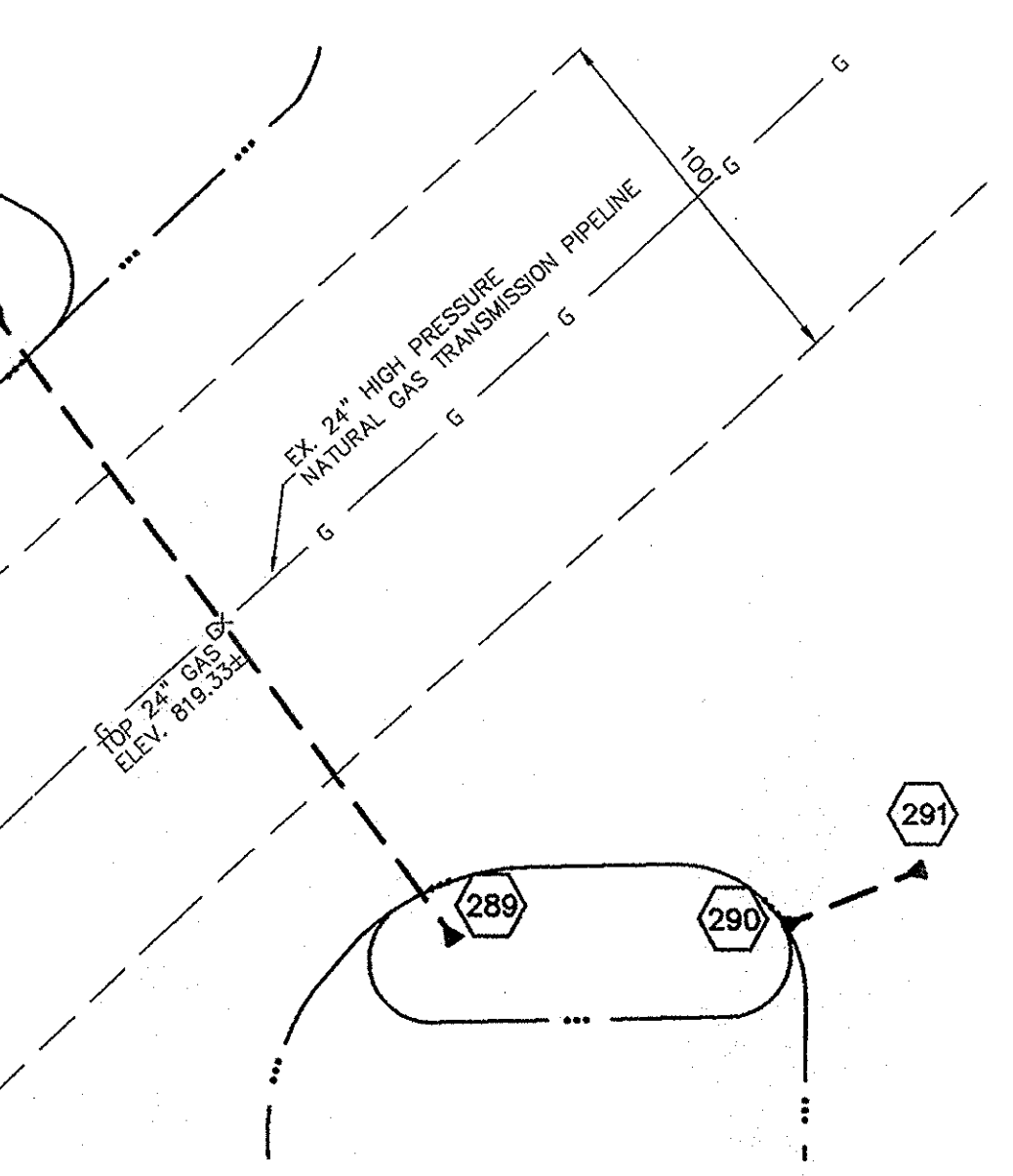
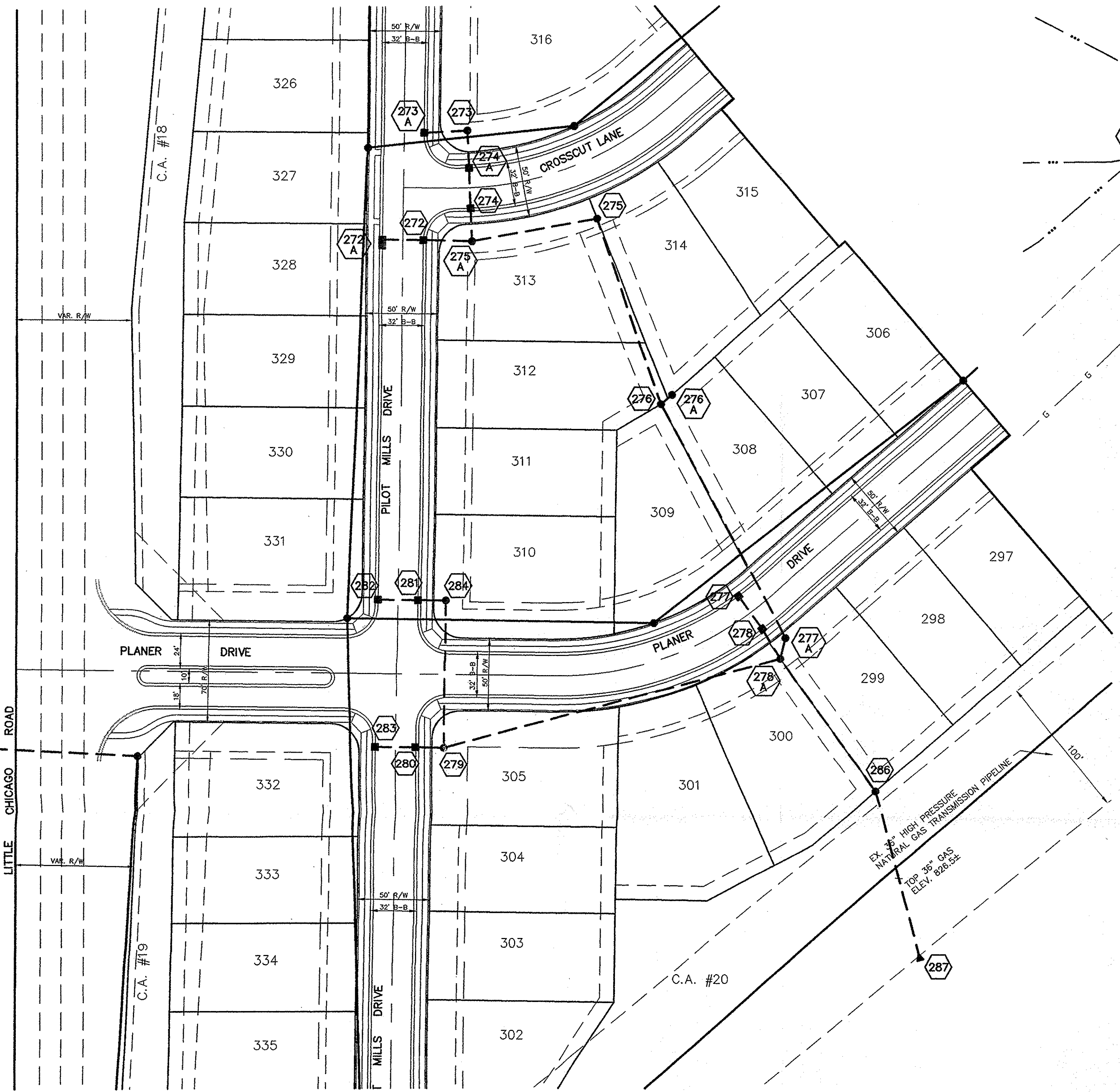

NOTE TO CONTRACTOR:  
BEFORE INSTALLATION OF PIPE BETWEEN STR. 286 AND STR. 287, THE CONTRACTOR SHALL HAVE STOEPPELWERTH & ASSOC. STAKE THE CROSSING AT THE GAIN. CONTRACTOR TO THEN CONTACT MARK WOOD AT 733-3232 TO HAVE HIM VERIFY THE GAS MAIN DEPTH PRIOR TO CONSTRUCTION.

**DANGER! USE EXCESSIVE CAUTION!** PANHANDLE EASTERN PIPE LINE COMPANY HIGH PRESSURE NATURAL GAS PIPELINES. PANHANDLE MUST BE NOTIFIED (DIRECTLY AT 317/873-2410 AND THROUGH THE ONE-CALL CENTER AT 1-800-382-5544) TWO (2) WORKING DAYS IN ADVANCE OF ANY ACTIVITY WITHIN ITS EASEMENT AND HAVE A REPRESENTATIVE PRESENT DURING ANY EXCAVATION OVER OR ADJACENT TO ITS PIPELINES.

SCALE: 1" = 50'

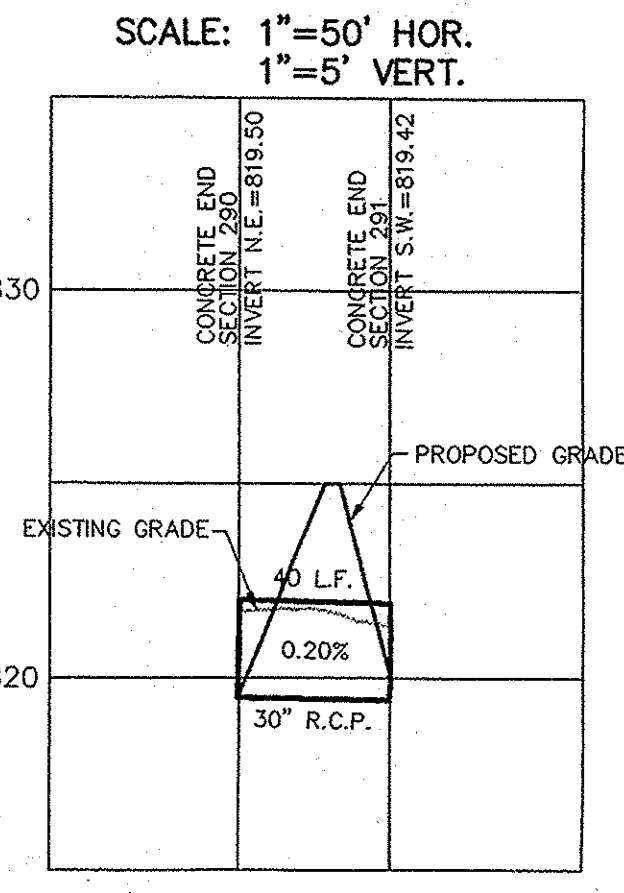
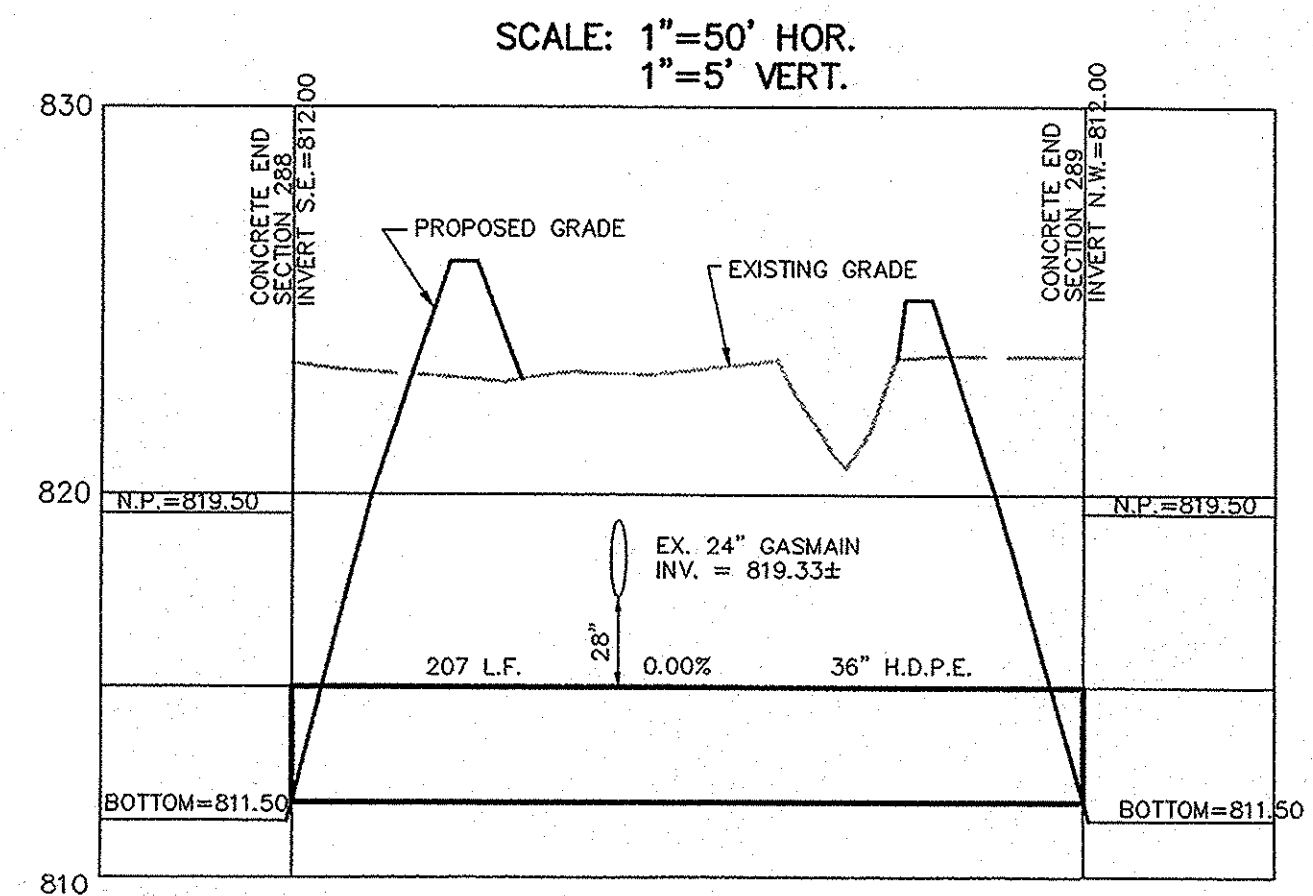

This information was gathered for input into the Hamilton County Geographic Information System (GIS). This document is considered an official record of the GIS.  
Entry Date: 2-27-2009  
Entered By: JLM

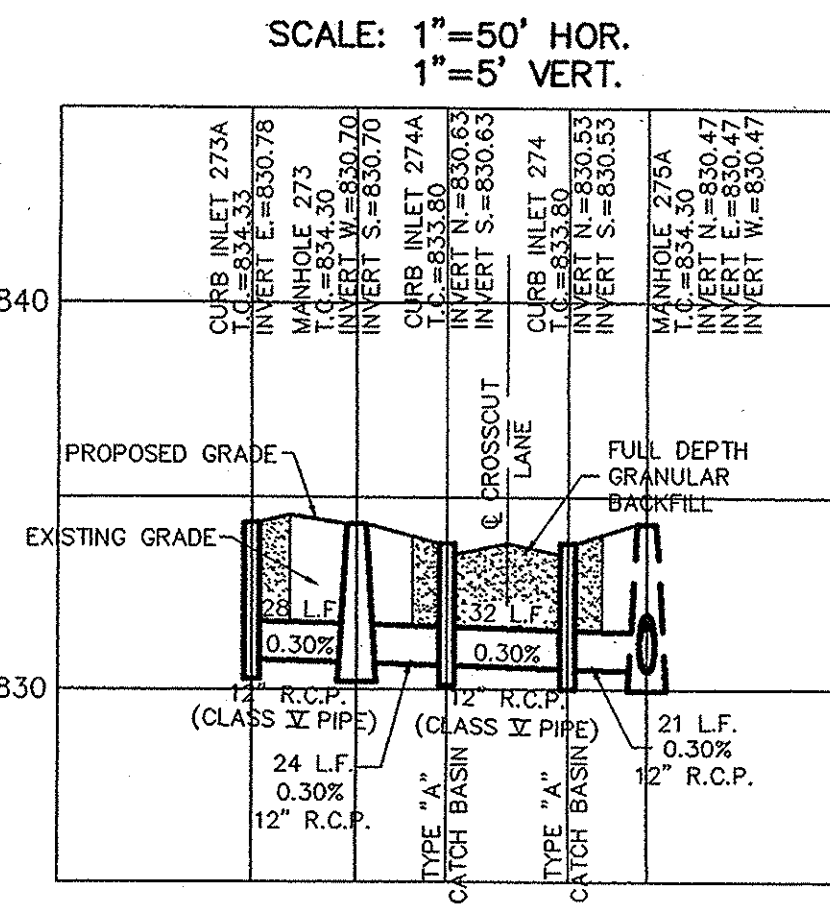
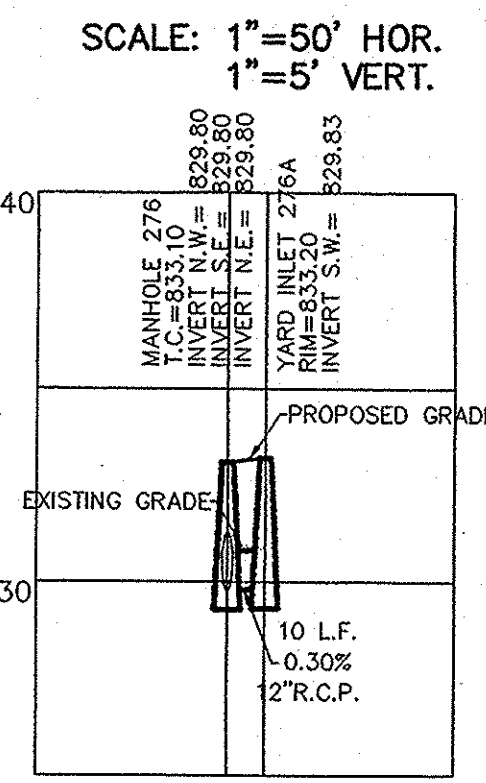
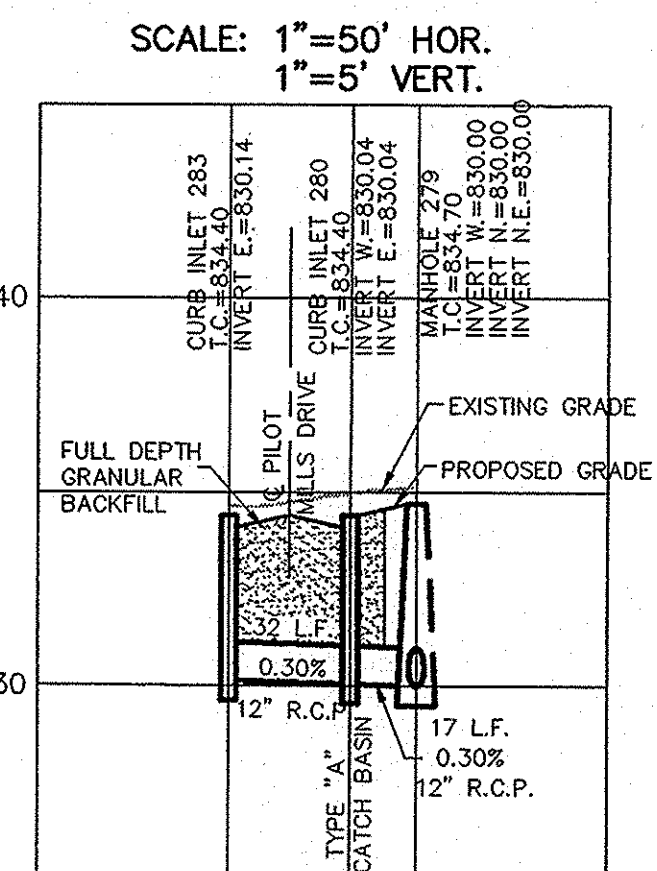

NOTE:  
ALL STORM SEWER PIPE TYPES ARE TO BE CLASS III UNLESS OTHERWISE NOTED.

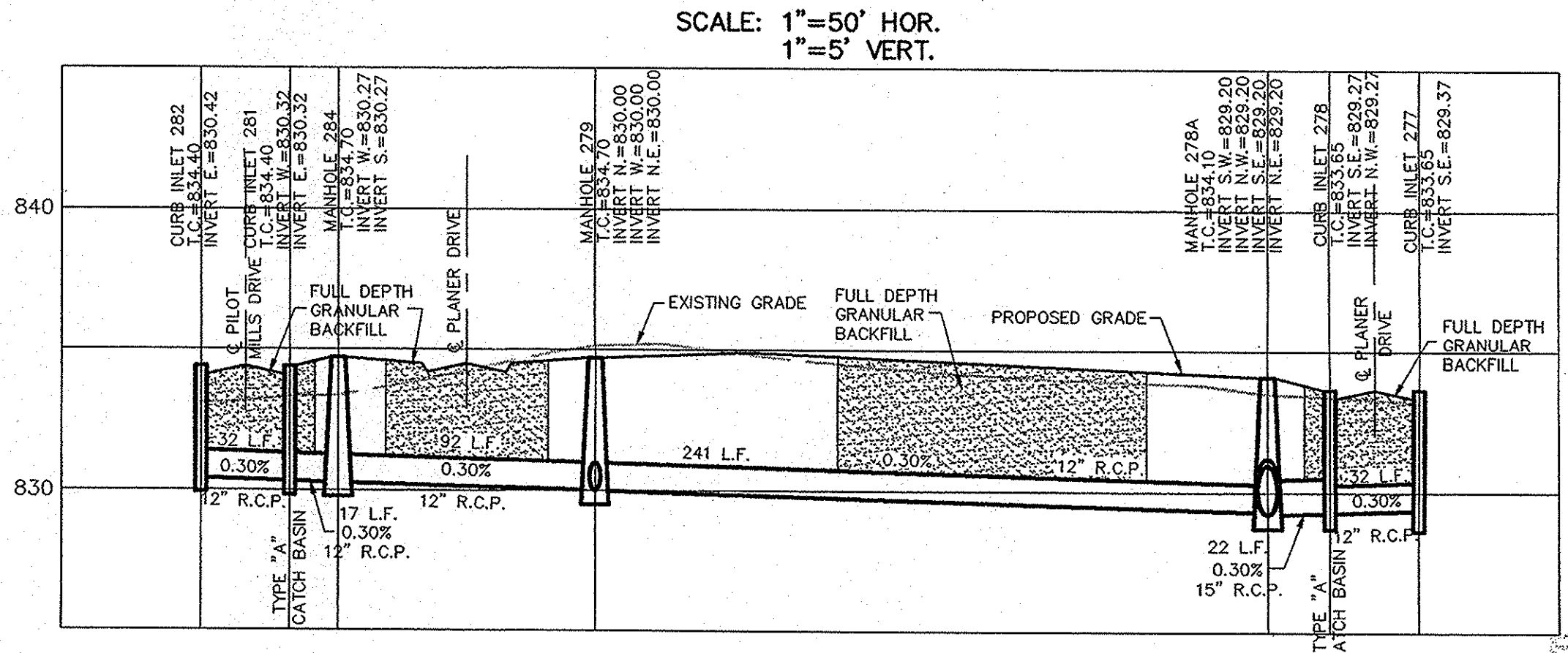
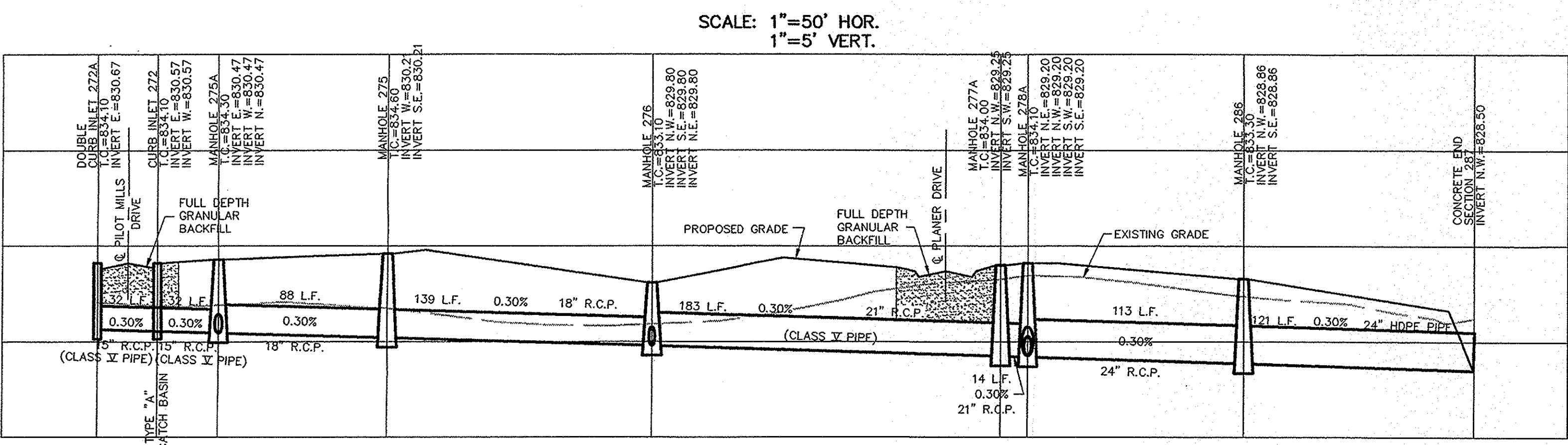

CONSULTING ENGINEERS - LAND SURVEYORS  
 (317) 849-5935 1-800-728-6917 FAX: (317) 849-5942  
 INDIANAPOLIS INDIANA  
 David J. Stoepelwerth  
 CERTIFIED: 1/25/02  
 DATE: 1/25/02  
 SCALE: 1" = 50'  
 REV. PER DEVELOPER COMMENTS: 1/25/02  
 REV. PER IBA COMMENTS: 3/29/02  
 REV. STORM AND PROFILES: 6/25/02  
 BAH  
 BAH  
 BAH  
 BY

**STORM SEWER PLAN & PROFILE**  
**MILL GROVE SECTION SIX**  
 NOBLESVILLE INDIANA

This copy is from the Digital Archive of the Hamilton County Surveyor's Office; Noblesville, In 46060